

TO ELIMINATE CUP WARDER
SM-205499
EIA 702 10/1

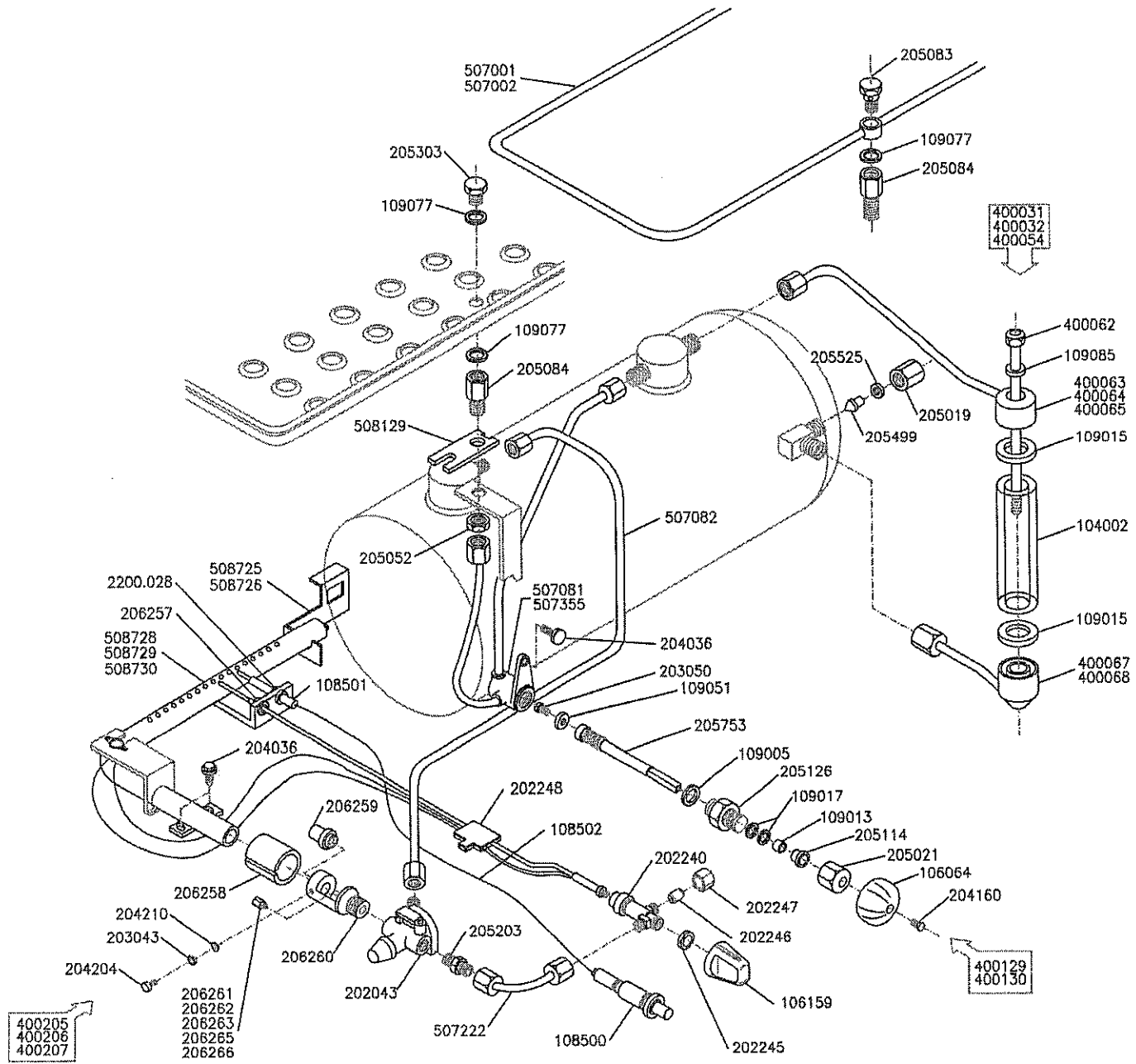

CODICE	DESCRIZIONE	DESCRIPTION
104002	Vetro pirex livello	Sight glass pirex
106064	Pomello scaldatazze	Cup warmer knob
106159	Pomello rubinetto gas	Gas faucet knob
108500	Accenditore piezoelettrico	Piezoelectric ignition
108501	Candela accensione piezoelettrico	Piezoelectric ignition plug
108502	Cavetto connessione per piezoelettrico	Connection cable-piezoelectric
109005	Guarnizione scaldatazze	Cup warmer gasket
109013	Stoppaccio	Wad
109015	Guar. tenuta livello	Seal- sight glass
109017	Guarnizione OR 107	Seal O-ring 107
109051	Guar. scald.-gruppo FCS	Gasket- cup warmer/FCS group
109077	Guarnizione	Seal
109085	Guarnizione asta livello	Seal- connection rod
202043	Regolatore automatico gas	Automatic gas adjuster
202240	Rubinetto gas valvolato	Globe valve for gas
202245	Dado fiss. rubinetto gas valvolato	Fastening nut for globe valve
202246	Boccola rubinetto gas valvolato	Bushing for globe valve
202247	Dado fiss. tubo per rub. gas valvolato	Fastening nut for globe valve tube
202248	Termocoppia interrotta + termostato 140°	Thermocouple + thermostat 140°
203043	Dado inox 5MA	Stainless steel nut 5MA
203050	Vite OT 4x8 TCCI	Screw OT 4X8 TCCI
204036	Vite 8,8 6x14 finta rondella zincata	Screw 8,8 6x14
204160	Vite inox 3x12 TPS	Stainless steel 3x12 TPS
204204	Vite inox M5x20 TCCE UNI 5931	Stainless steel M5x20 TCCE UNI 5931
204210	Rondella inox esterna da 5	Stanless steel external washer
205019	Dado 3/8" gas foro ø 8	Nut 3/8" gas hole ø 8
205021	Dado 3/8" gas foro ø 10	Nut 3/8" gas hole ø 10
205052	Dado 1/4" gas vaporizzatore	Nut 1/4" gas
205083	Dado serp. scaldatazze 3-4 gr.	Nut - cup warmer serpentine 3-4 gr.
205084	Niples serp. scaldatazze	Nipple - cup warmer serpentine
205114	Premistoppa scaldatazze	Wad pusher - cup warmer
205126	Corpo vitone scaldatazze	Screw body - cup warmer
205203	Niples 1/4"x1/4" foro ø 8	Nipple 1/4" x 1/4" hole ø 8
205303	Gicleur vapore scaldatazze 2 gr.	Steam gicleur - cup warmer 2 gr.
205499	Otturatore per tubi 5-6-8	Blind plug for pipes 5-6-8
205525	Rondella snodo vaporizzatore	Washer
205753	Vitone scaldatazze	Cup warmer screw
206257	Dado fissaggio termocoppia	Fastening nut for thermocouple
206258	Ghiera registro aria	Air adjusting ring
206259	Boccola diff. 2/3/4 gr.	Bushing
206260	Corpo porta gicleur	Gicleur holding body
206261	Gicleur GPL Ø 0,4	Gicleur-GPL Ø 0,4
206262	Gicleur GPL Ø 0,55	Gicleur-GPL Ø 0,55
206263	Gicleur GPL Ø 0,65	Gicleur-GPL Ø 0,65
206265	Gicleur metano Ø 0,80	Gicleur-methane Ø 0,80
206266	Gicleur metano Ø 1	Gicleur-methane Ø 1
2200.028	Dado fissaggio candeletta acc.	Nut
400031	Livello 85/95-2/3 gr. Completo	Complete sight glass unit 85/95-2/3 gr.
400032	Livello 85/95-4 gr. Completo	Complete sight glass unit 85/95-4 gr.
400054	Livello 85-Practical completo	Complete sight glass unit 85-Practical
400062	Tirante inox	Stanless steel rod
400063	Corpo sup. livello 85/Pract.	Sight glass -upper part 85/Pract.
400064	Corpo sup. livello 85/95-2/3 gr.	Sight glass -upper part 85/95-2/3 gr.
400065	Corpo sup. livello 85/95-4 gr.	Sight glass -upper part 85/95-4 gr.
400067	Corpo inf. livello 85/95-Pract./2/3 gr.	Sight glass- lower part 85/95-Pract./2/3 gr.
400068	Corpo inf. livello 85/95-4 gr.	Sight glass- lower part 85/95-4 gr.
400129	Scaldatazze completo 2/3 gr.	Complete cup warmer 2/3 gr.
400130	Scaldatazze completo 4 gr.	Complete cup warmer 4 gr.
400205	Dispositivo gas completo 85-2 gr. inox	Complete gas device 85-2 gr.-stainless steel
400206	Dispositivo gas completo 85-3 gr. inox	Complete gas device 85-3 gr.-stainless steel
400207	Dispositivo gas completo 85-4 gr. inox	Complete gas device 85-4 gr.-stainless steel
507001	Serpentina scaldatazze 3 gr.	Cup warmer serpentine 3 gr.
507002	Serpentina scaldatazze 4 gr.	Cup warmer serpentine 4 gr.
507081	Corpo scaldatazze + tubi 2/3 gr.	Cup warmer body + pipes 2/3 gr.
507082	Tubo caldaia-fornello 85/95	Tube- boiler/burner 85/95
507222	Tubo sicurezza gas 85/95-2/3/4 gr.	Tube- gas safety 85/95-2/3/4 gr.
507355	Corpo scaldatazze + tubi 4 gr.	Cup warmer body + pipes 4 gr.
508129	Staffa ancoraggio	Anchoring stirrup
508725	Supporto fornello gas Mod. 2 gr.	Support for burner-Mod.2 group
508726	Supporto fornello gas Mod. 3-4 gr.	Support for burner-Mod.3-4 group
508728	Supporto fornello gas Mod. 2 gr.	Support for burner-Mod.2 group